

cnYES Office

鉅亨網辦公室

設計者」水相設計 / 李智翔
參與者」郭瑞文 張森賢
攝影者」岑修賢
空間性質」辦公室
坐落位置」臺灣
主要材料」大理石、竹皮、鍍鈦、鐵件、地毯、皮革
面積」248 坪
設計時間」2015 年 9 月至 11 月
完工時間」2015 年 11 月至 2016 年 3 月

Designer」 Waterfrom Design Co. Ltd. / Nic Lee
Participants」 Richard Kuo, Sam Chung
Photographer」 Sam Tsen
Category」 Office
Location」 Taiwan
Materials」 Marbles, bamboo veneer, titanium plated metal, metal, carpet, leathers
Size」 820m²
Design period」 September - November 2015
Completion period」 November 2015 - March 2016

水相設計 / 李智翔

水相設計設計總監
丹麥哥本哈根大學建築研究
紐約普瑞特藝術學院室內設計碩士
重要得獎紀錄
2015 亞太室內設計大獎 APIDA Excellent Award
2014 亞太室內設計大獎 APIDA Best 10
2013 臺灣室內設計大獎 住宅空間類複層、單層 TID 獎
2012 臺灣室內設計大獎 住宅空間類複層、工作空間類 TID 獎
2011 臺灣室內設計大獎 住宅空間類單層 TID 獎
2011 國家金點設計獎
2011 臺灣室內設計大獎 《2007~2010 臺灣十大設計師》
2010 國家金點設計獎

Waterfrom Design Co. Ltd. / Nic Lee

Design Director of Waterfrom Design Co. Ltd.
Denmark University of Copenhagen Architecture study
New York Pratt Institute Master of Interior Design
Main Award Records
2015 Asia Pacific Interior Design Award
2014 Asia Pacific Interior Design Award
2013 Taiwan Interior Design Award, Residential space multi level, single level TID awards
2012 Taiwan Interior Design Award, Residential space multi level, Office space TID awards
2011 Taiwan Interior Design Award, Residential space single level TID award
2011 National Gold Pin Design Award
Taiwan Interior Design Award (2007 to 2010 Top 10 Taiwan Designer)
2010 National Gold Pin Design Award

Nic Lee



灑灑灑灑之渦漩，如雲如水做螺紋狀高低盤旋，此團型天花構造在大廳頂勁鬱騰捲，定止間韜韞著靜極思動的潛勢；繼之向內轉進，天花遞嬗成片狀淺藍外觀，其貌似恣涌醴泉與筆直廊道上下駢進，如此從渦漩直至湍滂滾馳的水脈，象徵了金錢彙集、涓滴成流的隱喻。在這次跨足網路媒體與投顧的企業辦公室，李智翔從「財如水」金融意象來破題，自門戶起點便摹繪富貴衍若暢旺活水澎湃不息的意蘊。而為體現企業創新、沉穩兼容並蓄特質，設計再引懷舊語彙和當代藝術風格兩兩鑄鎔，超現實意象間透著頹美澹彩的材料膚觸，形成一次風格游離的書寫。

渦漩活水 描錢潮奔揚

鉅亨網作為科技金融企業，主體事業涵蓋財經網路媒體及證券投顧，從而意象塑造上，自然有了錢脈滔滔、殷阜綿綿的隱喻，因此 200 餘坪開曠辦公室自門戶起，便從天花與動線關係勾摹一種奔揚推進的「錢潮」旨趣。顧盼接待區，設計藉預鑄石膏在天花疊出多層次渦漩構造，以擬比財富纂聚如匯，而掠過玻璃門扉，裝飾語彙幡然一轉，漆成淺藍色之天花開始依循著空間廊道曲折移進，意取金錢猶似潮水霽霽然湔湧。對此李智翔談到：「鉅亨網和金錢有關，所以就從財富聚沙成塔、涓滴成流作為意象。因此接待區用盤旋式天花表達一種聚集，匯合後，再將比擬水的藍色系天花朝內一路流動。」不僅如此，包括櫃檯紅銅鍍鈦、圓形金屬門把，諸種細節皆在指涉錢幣此一語彙。

富含象徵性的空間起點營造了寫意流動感，格局鋪陳則能從 L 型廊道讀出脈絡。轉進核心場域，能見 L 型廊道順循著會議室輪廓勾畫，緊鄰窗牖的第一條廊道軸線，鬆開接待區與開放辦公室的距離，垂直銜接第二條廊道軸線，則利用吧檯、食品櫃及流理檯創造出開放性茶水間。坦迤無輟 L 型長廊迎著滿窗牖自然光，韻味倘然暇豫，而為保持這般豁達氣象，設計再採玻璃來框構會議空間，使水平景深無斷。會議室穿透感皮層雖是通透明白，但層次與立體感稍有不足，於是地毯以玻璃為界，外為灰、內為靛青，讓外觀洋溢著儼如濾鏡般的奇異效果。

解構之鐘 愛麗絲之椅

延續著金融氛圍、經濟趨勢雲譎波詭之莫測，因此設計從“Time is money”為概念創造會議空間主視覺，對此李智翔談到：「業主希望顧客來到會議室能感受強烈的 image，不必然是圖騰式的，所以就從“Time is money”來發想，最後用了一道鐘來詮釋這種概念。」為增強趣味性，設計將大圓鐘形體解構，讓黑線輪廓存在被撕開的罅隙，探看究竟，其乃由數段弧狀金屬構件做前前後後懸吊固定，才醞釀成水平斷裂、垂直錯疊的組織感，如此飄浮又靜默恆定，儼如鐘體坍塌瞬間的凝結。事實上藉著光線，最終投射於牆的鐘影將是完整輪廓（見圖 3），實有缺，虛為全，是設計之外一場辯證邏輯遊戲。

1. 接待區，螺紋狀造型天花除了比擬財富如水匯聚，其多層次亦為收納管線而生。
1. Reception has a whirl shaped ceiling representing the collection of fortune. The various level are for utilities and wiring.



2

2. 從會議室瞻望整條廊道，垂直、交錯鐵件線條以窗臺為背景形成畫面，低淺照明中，洋溢時髦且溫馨的情調。3. 會議室吊鐘插圖，表達投影效果。4. 自接待處轉進開放辦公區前，會行經一綿長廊道，與之相應的水藍色天花不僅勾勒空間軸線，也暗喻金錢流（接待區螺旋天花）向內奔騰的意象。

2. View of the main corridor from the conference room. Under the low luminaries, linear metal elements with the window framing background reveal a stylish and cozy atmosphere. 3. Conference room suspended clock with projection effect. 4. The aqua blue ceiling corridor connecting the reception area to the open office zone symbolizes the fortune flowing inward imagery.



不僅鐘體，L 型廊道上亦有超現實韻味的藝術裝置。包括從“chair bench”概念來發想，將廊道旁三座落地窗臺視為長凳，傳統椅背再直接架接其上，悖離常識和經驗原則的物件，有詼諧詭誕的意趣。繞往另一側廊道，具備休憩及展示功能的一側吧檯，外觀乃是 9 張高聳巨型椅，靛青色椅背拔高觸頂，寬且深之椅座則實為方桌機能，每每自遠嚼味這幅廊道景致，驀然好似跌落《愛麗絲夢遊仙境》的兔洞，人體猶如微縮下之於空間場景，闖進了軼失奇幻文學一篇章。

類唐風格 寫與蹟古邈

解構之鐘、渾放超現實精神性造型椅，這些元素鑄刻了李智翔對空間的「當代藝術」風格思維面相。事實上，鉅亨網經營網路媒體及投顧公司，因此業主冀盼場域調性是「創新又不失穩健」，如此脈絡下，設計便提出「懷舊」（reminiscence）與「當代藝術」（contemporary art）結合的主軸，前者鉤沉一股與蹟古邈情雰，後者穩固前衛、與時俱進印象，對此李智翔解釋：「這兩個概念是衝突的，但我想運用的復古，是質材上擷取陳舊風格那面，接著再用不鏽鋼或相對鮮豔的顏色去定義空間。」

切題創新而內蘊沉穩，於是李智翔在接待區立面以白色竹皮鋪覆，一來取竹材柔韌能曲、易熨貼牆之弧度來行使，二擇其稟性輕淳澹美、竹節浮凸立體，形與質皆能遞送人文韻致；至於清爽淺色有洗鍊的當代氣韻，尤其壁面竹皮以垂直、傾斜等方向錯疊拼貼來陶鎔質地美，錦繡內斂但能自華。包括一處廊道隅角盡為竹皮材料，但藉黝黑背景與嫩綠懸空立方櫃對比，質材典雅、用色卻釋出當代力道，讓端景飄逸著抽象海報風格。至於地面則尋覓復古感毯料，其貌似某種鏽蝕、擦拭與褪色之陳舊皮層，藉顏色相對不飽和與紋理無序孳蔓，形構出老件般時光感。這種材料意念也投射於茶水間牆垣，設計以細長而攜溫潤色之磁磚描摹出義大利鄉村味的古樸氣息。

復舊語彙亦滲入會議室，清玻璃圍塑之空間利用鐵件為框架，除當代氣質濃厚之垂直水平結構，李智翔再加上交叉、閃電線條來豐盈整體複雜度，淡化太簡約的當代風格。至於懸吊解構圓鐘的牆面，設計將三釐米厚板材敲碎後再拼貼，達到李智翔口中「不是洗鍊、縝密而完美的狀態」，藉此緬憶斷垣殘壁那歷史性場址，一種雅典衛城般的天蝕人毀風霜，讓這一幕，混糝著西元前遺跡所蘊藉之類唐浪漫。採訪 劉芝君





5



8



6



7

5. 會議室內以藍色地毯和牆面創造相對於廊道的灰，有場域界定之效；交錯鐵件線條則豐富了視覺感。6. 科技金融產業講究效率，因此會議室以「時間即金錢」為概念，在一道仿古斑駁牆面懸起解構感吊鐘。7. 利用線纜懸吊鐘體結構。8. 一大兩小會議室以活動式隔屏為界，需要時可完全收攏，讓三間會議室整合為一。9 室內天花與走道動態，插圖表達金錢如水流的概念。10.11.12. 會議室利用活動隔屏，創造出摺閱自如空間運用。

5. Blue carpet and walls conference room contrasts the gray tone corridor. Not only to define the spaces, decorative linear metal trims also enrich the visual interest. 6. Financial technology industry pays great attention to efficiency, therefore "time is money" is the main concept for the conference room feature wall. A modern suspended clock hangs in front of a old time charming wall. 7. Cable suspension structure. 8. Three different size meeting rooms with retractable partitions that can create one large conference space when needed. 9. From reception area to open conference room corridor and ceiling. The illustration represents the flow of money. 10.11.12. Moveable partitions create various size of conference spaces.

建材分析 Material Analysis

1. 材料上希冀勾勒一種懷舊韻味，地面以紋理具有陳舊感的地毯來呈現。
2. 地毯有五種以上樣式，實際鋪砌前需要先用做摹擬，漸層效果能夠自己安排，營造出本案所需斑駁感。
3. 接待區立面以白色竹皮拼貼出縱向、斜向紋理，外緣再以鍍鈦收邊，創造陰影效果。
4. 接待區地面為寬刷紋大理石。
5. 天花板系統為一種 GRG 預鑄石膏。
6. 會議室的解構鐘以線纜固定。
1. Using old fashioned floor pattern and texture carpet to frame out the reminiscence flavor . 2. There are more than five carpet pattern design combinations, therefore on site mockups were required prior to final installation. Desired color gradual effect was fine tuned to achieve a time passing feel. 3. On the entry wall, white color bamboo veneer with specific grain pattern with titanium plated edging to create a delicate shadow line. 4. Reception area with generous wide grain marble flooring. 5. GRG reinforced gypsum molded ceiling product. 6. Conference room wall clock is suspended by a cable.

溝通重點 Communication Note

1. 業主期盼空間具備科技公司的韻味，但又不失金融機構的氛圍。
2. 基於前述金融科技公司的定位考量，空間必須反映創新與穩健兩種特質。
3. 業主有風水考量，因此原先配置給主管的角窗辦公室，最後留給人力資源部使用。
1. Owner was interested in a new office space for a high tech company in a financial company environment. 2. In consideration of a financial technology company market definition, the office space needed to reflect both innovation and stability. 3. Owner believes in Feng Shui, therefore corner offices were reserved for the human resources department.

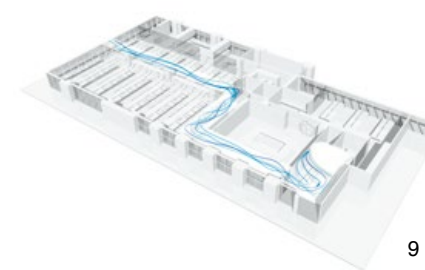

9

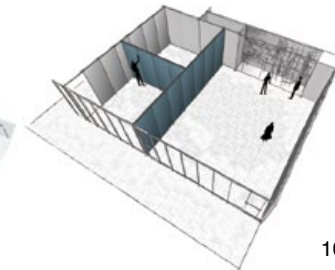

10

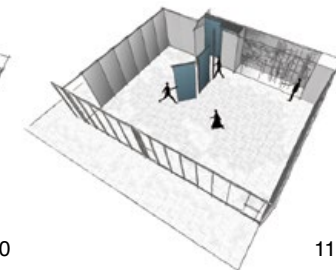

11

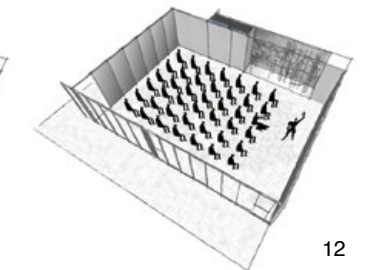

12



13

13. 自廊道瀏覽打開的會議空間，藍色皮革牆面與靛青地毯，與外側灰色廊道形成色差。14. 會議室另一端廊道為簡易流理檯與食品儲藏櫃，復古紋理和藍色調向此延續。15. 流理檯細部，橘紅色磚體砌出牆面，在當代感空間流露著一股懷舊溫潤質感。16. 巨型椅組成的吧檯區不僅流露地景裝置趣味，更具備收納、展示與休憩討論三種機能。17. 小會議室轉角處的端景，利用黑、嫩綠兩種顏色竹皮創造對比。18. 位於廊道底端處的小會議室，頗有咖啡小館韻致。13. View from the corridor to the completely open conference space. blue leather fabric wall with indigo color carpet contrasts with the gray tone corridor. Accompanied with glazing interface to create filter glass visual affect. 14. Other end of the corridor is the kitchenette and food storage cabinets. Blue color tone with old fashioned texture finishes continued. 15. Kitchenette counter detail. Orange color brick wall constructs the reminiscence elegance within the modern space. 16. Opposite side of the counter, nine large scale chairs are not only an installation art work but also function as storage, display and allow for rest use. 17. Corner view of the small meeting room. Black and green bamboo veneer color contrasts to create a strong poster style. 18. Small coffee bar style meeting space located at the end of the counter.



15



16



14



17



18

Water flows in a vortex motion, whirl shaped entry hall ceiling represents the collection of fortune, the ceiling structure contains the movement's energy. From the beginning an inverted collection, the spring flow along the corridor as a running stream, symbolizes the wealth accumulation like water trickling into a stream. Stepping into this internet media and investment firm office design, Nic Lee based the design on the idea of "Fortune as water" starting from the entrance that expresses wealth like running water in an endless stream. To reflect the innovative yet steady inclusive character, the prime design vocabulary of reminiscent and contemporary art style coexists. Surreal imagery reveals a decadent material beauty, the formation of a free -style writing.

Flowing water vortex Wealth flow

cnYES is a technology giant financial firm as the main business covers internet financial media and investment consulting, thus naturally shaping the office image of the wealth and surging money metaphors. The 820 square meters open-floor office space, presents the "money flows" imagery though the formed ceiling continuing through the circulation lines. The reception area precast plaster ceiling is stacked as a multi-layered vortex structure. It intends to also represent the compiling of wealth. After passing the glass doors the design vocabulary takes a turn. The painted light blue ceiling begins to follow the winding corridors, meaning the fortune will flow like a water surge. Nic Lee said: "The firm finance related, the accumulation of wealth just like water trickling down into the stream flows all the way towards the spaces. Not only that, the counter comprising titanium copper, round metal door handles, unite all the details in this coin-referential vocabulary."



19

19. 開放辦公區，悠長的白色天花延續著廊道淡藍色天花而來，不僅抓出空間的主動線轉折，也潛藏著錢脈如滔滔河水的設計意象。20. 天花照明佈局隱含一種線性，不完美對稱亦不失序，定中求變。



20

19. Open office zone, continuous white ceiling marches along the light blue corridor ceiling as an indicator of the office circulation and also as metaphor of continuous money resources. 20. Ceiling lighting linear movement layout, no perfect symmetrical order.

The symbolic space is the starting point to create a sense of movement laid out in a pattern to form the L-shaped corridor context. Turning into the core, visible along the L-shaped corridor that follows the outline of the conference room, it is adjacent to the first corridor of axis released from the reception area into open offices. Connected to the second corridor axis, the use of the bar counter, pantry and storage units create a open kitchenette. The L-shaped corridor is filled with natural light. In order to continue the relaxing atmosphere a glass panel was designed to block the configurations of the meeting space which are framed in clear glass. Also utilized is a color differential that enhances the visual depth, the carpet to the glass sector is gray outside, inside it is indigo, filled with an exotic filter-like effect.

Deconstructed clock, The chair of Alice in Wonderland

In reflection of the economic trends and financial climate deceitful and inscrutable, the design idea of "Time is money" creates a meeting space with visual cues of which Nic Lee said: " Owners want the customers to experience the strong images while in the conference room, and decided on using a deconstructed clock. To enhance the fun, the designer deconstructed the clock. The presence of the black outline is made with suspended metal arc segments, the organization formed among the horizontal and vertical offsets, silent it persists. Through light projected onto the wall, a shadow complete s the clock profile. Between the void and solid, it is a dialectical logic game design.

Not only the clock but the L-shaped corridor also filled with surreal style art installations. Inspired from a "chair bench" concept, three sets of window frames are regarded as benches, departing from common sense and experience of objects with sensible charm. Around to the other side of the corridor, with the open side of the bar and display functions is the appearance of nine towering giant chairs. An overstating indigo color chair back peaked, its broad and solid depth seating functions as able.

Viewed from the distant, as if suddenly falling into the " Alice in Wonderland" rabbit hole, falling into a fantasy literature chapter, under this miniature scene.

Deserting romantic style, rewriting the stylish fine details

Decon style clock, surrealism type chair, these elements symbolize Nic Lee's "contemporary art" design style. In contrast, the project client - cnYES internet Edina network management and investment consulting firm, their space expectation were of "innovative yet stable". With these sources of context, Mr. Lee proposed the project design concept combine "reminiscence" with "contemporary art". As the designer explained: "theses two concepts basically are contradictory, but I wanted to utilize the textural quality portion of the reminiscence style with stainless steel and bright color to define spaces."

With the idea to combine innovation with serenity, Mr. Lee utilized bamboo's veneer material strength, flexible and easy to work with quality to deliver a humane charm in the reception area followed by a fresh interpretation of bright colors. This provided a relatively contemporary character, especially with the bamboo veneer's directional texture as the expression of restrained beauty.

Similar material expressions were also reflected on the pantry wall, warm color and slim style tiles depict the Italian countryside quaint atmosphere; just around the corner, a suspended cabinet with a similar bamboo veneer has a dark background in contrast with the green color volume to express the material elegant quality and contemporary color strength. Flooring material is also a nostalgic blanket material. It looks like some kind of rusty, stale and wear-out discolored layer, Its relatively unsaturated colors and textures propagate disorder and a shaped configuration of the sense of time.

This vocabulary also penetrates the conference room which is a clear glass-enclosed space with iron framework. In addition to the contemporary style of the strong vertical and horizontal structure, Nic Lee coupled it with cross-shaped lightning-type lines to the enhance the of overall complexity and minimize the modern style. As for the suspended deconstructed round wall clock it was collaged from purposely broken 3 mm thick sheet material to achieve the designers idea about a "not meticulous and perfect line" that recalls the historic ruins at the Acropolis. This weathered scene reminds us of the unique deserting romantic.