

Tango of Life

生命的探戈

設計者」 城市室內裝修設計有限公司 / 陳連武

參與者」 黃玉枝 張涵敬

攝影者」 賴壽山

空間性質」 婦產科暨生殖醫學中心

坐落位置」 台灣

主要材料」 3M 表面材、壁紙、美耐板、磁磚、玻璃、導電地板

面積」 178 坪

設計時間」 2016 年 8 月至 9 月

施工時間」 2016 年 10 月至 2017 年 2 月

Designer」 Chains Interior / Lien-Wu Chen

Participant」 Yu-Zhi Huang, Han-Jing Zhang

Photographer」 Shou-Shan Lai

Category」 Fertility Clinic

Location」 Taiwan

Materials」 3M finish board, wall covering, plam, tile, glass, static dissipative flooring

Size」 588m²

Design period」 August – September 2016

Construction period」 October 2016 – February 2017



設計視空間水平皮層為圖紙，

以黑色描邊穰集重疊的卵形輪廓、再霑塗藍黃兩色於其中，

藉此演繹胚胎分裂意象；隨之天花導入黑框圓鏡汲染地面斑斕形質，

讓偌大場域色彩虛虛實實相生相映、影姿上下蹀躞。

球體流線 直書生物型態

歸返人類孕育生命之初來闡述的「生基婦產專科暨生殖醫學試管嬰兒中心」，設計挪用精卵、胚胎及子宮形體來摹繪空間輪廓，藉形象化方法，讓場域本質能直觀被領略和解讀。鑲嵌於 20 年老華廈內的基地，樓層以梯廳為中軸界劃出左右兩塊分區，並由一條廊道牽成兩端溝通動線。巧取梯廳、廊道間存嬗遞再入動態，設計師陳連武便由此處空間楔子直書破題氣象，因而從梯廳向內轉進，立面及端景有珠圓玉潤的球體以疏密、大小不等姿態灑灑如川沉浮著，彼此間儼若一場覓愛追歡，藉以闡述精卵邂逅；至於廊道弧狀立面則塑成先窄後寬漏斗形，隱喻女性子宮構造。

對此陳連武談到：「整個梯廳想營造一種探索趣味，梯廳先由發亮的球體引導，接著進入刻意壓縮、生物型態的廊道，就好像精子卵子結合前的序曲和旅程。」若紆綫動線是一場意蘊深綿的翫索，騰懸於長廊隅落的三道球體則屬諧譜伏筆；由於球體裝置縮在一內凹小空間，非與廊道牆垣齊線位，於是設計從視角戲法，將其一大球體慧黠地鼓出立面，每逢躡步遊走廊道時便可窺得一圓凸球面半露，好似有位大腹便便孕婦正立身牆後，躍然生動。

自梯廳右側轉進後因朝向長安東路褊狹巷弄，景象紊亂，因而分區歸納了手術室、取精室、實驗室、凍卵室等講究隱蔽和隔離無菌的空間；梯廳左側則氣象幡然，壤接一處擁長窗牖及蒨蔓路樹映襯的和豫之所，情霏頗是宓穆安舒，設計順應地理條件在此置入接待區，人驀忽邁進，即襲上嗷嗷燦陽和滿窗釉綠的櫛椽嘉樹，第一印象感受性極佳。此區亦是問診和諮詢室所在，有陳連武用雋朗空間感關照醫者工作、患者求診情緒的深意。

音律色彩 演繹胎孕之初

格局底定後，空間外入內的敘事同樣韜韞了生命遞衍之喻。首先，接待區線條形體再延續梯廳生態意象，唯原先精卵邂逅的狀態邁入（受精卵）結合，陳連武以交疊的圓及橢圓語彙作天花和地面組構，從而演繹胚胎分裂歷程；至於立面有機輪廓亦如子宮弧度，包覆著圓型座位區、天花地面所象徵的胚胎，攫捕胎孕之始的生命寰宇。

Lien-Wu Chen



城市室內裝修設計有限公司 / 陳連武
淡江大學建築系暨建築研究所畢業，其設計概念不僅強調內裝的重新鋪陳、設計細節，更善於以建築的宏觀，從整體上全面改良，擊劃更適於居住的合理化動線格局。重要得獎紀錄：2017 德國 Red Dot Award: Interior Design Winner · 2016 美國 Interior Design Best of Year Awards Honoree · 2015 美國 IIDA Global Excellence Awards Winner · 2015 德國 IF Design Award · 2014 日本 Good Design Award · 2014 義大利 A' Design Award Interior Space and Exhibition Design Silver · 2013 台灣室內設計大獎 居住空間類單層 TID 金獎 · 2013 美國 IIDA The Best of Asia Pacific Design Award 銀牌獎

Chains Interior / Lien-Wu Chen
Graduated from the Department of Architecture and Master of Architecture program, Tamkang University. His design concepts not only emphasize interior reconfigurations and design details, but he also specializes in overall building improvement.
Important award records: 2017 Germany, Red Dot Award: Interior Design Winner · 2016 USA, Interior Design Best of Year Awards Honoree · 2015 USA, IIDA Global Excellence Awards Winner · 2015 Germany, IF Design Award · 2014 Japan, Good Design Award · 2014 Italy, A' Design Award Interior Space and Exhibition Design Silver · 2013 Taiwan, Interior Design Award, residential single level TID Gold · 2013 USA, IIDA The Best of Asia Pacific Design Award

1. 梯廳立面用發光球體隱喻精卵邂逅之初。

1. Stair elevation and luminous sphere are metaphor of the engagement of sperm and egg.



2



3



4

2. 自梯廳轉進廊道，立面先窄後寬象徵了子宮。牆後半露球體則好似女性的孕肚。3. 利用鏡體加深空間的垂直深度，巧飾老建築尺度不足。4. 接待櫃檯收在牆側，但流線出光的體裁依舊醒目。5. 室內色彩僅往平面發展，立面則為瀟雅白色，讓醫療空間性質不至於流失。

採重疊卵形詮釋生物形體之餘，陳連武提及胚胎分裂即一分二，二分四洋溢韻律，而探戈樂曲亦是一個四分音符化為兩個八分音符，每個小節形成四個八分音符，那種節拍猶似細胞分裂一為二、二為四般切分繁殖出來，對此他解釋：「胚胎分裂一如探戈節拍，也可以想男女對舞一開始有種你不情我不願的感受，後來愈發難分難捨，那種歷程確實和整個生命歷程有強烈呼應。」生命像首探戈之曲，因此陳連武用穰集重疊的圓摹擬細胞分裂過程，亦象徵舞者載著節拍滑出的步伐。

婉變千姿雙人舞，秉持這份音律性想像，設計將空間水平皮層當圖紙，以黑色描邊卵形輪廓、再引大面積深淺藍佐以局部嫩黃露塗，藉此勾畫胚胎分裂意象，天花並導入黑框圓鏡汲染地面斑斕形質，讓整個接待區色彩虛虛實實相生相映、影姿上下蹀躞，一如彩鳥鼓翮繽紛流瀉。但除此之外，立面則是澹然素縞白牆，低處踢腳板則同用黑色來強化室內輪廓，藉無色調守住醫療空間的智性、科學之質。對於用色原則，陳連武更提出意涵飽滿的解釋：「大量的藍和局部的黃，就色彩



5

2. The gradually widening corridor elevation is symbolic of the uterus. The semi-exposed sphere behind the wall is like a woman's pregnant belly. 3. Use of mirror to deepen the visual depth of the space. 4. Reception counter along wall side, but the flow of light is still eye-catching. 5. Color scheme only development of the plan, the white elevations maintain the professional space of a health care environment.

學來說是量跟力的分配關係，藍色力量小，面積比例就相對大，黃色則有足夠能量，量體就小點。藍色彰顯醫學理性，黃色洋溢生命力，冷色系的藍和暖色系的黃，也象徵著男女兩性。最後再用鏡子創造高高低低的層次，映入顏色，豐富整個空間。」色彩不僅渾涵設計概觀，其餘空間作延續性純白乃是讓空間不悖離醫療空間本質，避免斷傷空間自明性。

空間四方體立柱也收成圓筒狀，點狀散落的鏡面烤漆茶几亦像顆顆飽滿卵子，讓環境闡溢著優潤和諧視覺感。而一道收於牆側的流線出光體則是櫃檯所在，上頭印著疏密不等的大小圓以形成遠近先後的視覺感，叢簇小圓點彷彿在液體中蕩滉浮游，或一種生物呼吸吐納，鮮活動勢表徵著飽滿生命能量。綜觀其姿態雖是相對內斂退在空間一隅，但這般翛然迤邐之有機發光體，也讓它有著毅然的存在。採訪「劉芝君





6



8

6. 診所接待空間，就著窗和綠樹打造成開放空間。7. 座位區和小茶几同樣用卵形語彙加以規劃。8. 立面為流線的有機輪廓，將梯廳所隱喻的子宮型態再次重現。

6. Clinical reception, open space with view and greenery. 7. Seating area with oval shape coffee table as the common design language. 8. Elevation with organic flow contours, reemphasize the metaphor of the uterus.

Streamlined sphere that illustrates the biologic model

Returning to the origin of human life was the main idea used to interpret this Obstetrics and Gynecology clinic and fertility center. Design figuratively describes the fertility process so the essence of the place can be intuitive and easily comprehensible. The project site is located in an existing apartment building, with a central stair case that divided the floor plate into two separate zones. Designer Chen cleverly utilized the stair hallway as the project introduction and guides progress as one enters the space. Various sizes of sphere marching along the funnel shaped corridor represent the sperm, eggs and uterus that expound upon the fertilization process. Chen explained that the entry sequence is the journey of exploring, lead by glowing spheres and then proceeding into the deliberately compressed and biologically shaped corridor. From the corridor perspective view, a large sphere can be seen half exposed wittily hinting at a pregnant woman standing behind the wall.

The designer conveniently organized the operating room, laboratory, and other spaces that require privacy and isolation on the right side of building. As opposed to the unpleasant street view, the left side of the building offers peaceful greenery for the clinic reception and consultation rooms. The space layout is sensible and caring for both patients and health care providers.

Vivid melody of life

Within the reception area, the fertility biology representational theme continues. Organic curved elevation embraced the rounded seating area, Chen Lianwu applied overlapping circles and oval vocabulary on both the ceiling and floor plane, various symbolic elements represent the progression of zygote into the cleavage stage. The embryo split is divided into two, then two split into four with a similar rhythm to tango music. That is a quarter note into two octaves notes, each section forming four eight notes. The biological rhythm corresponds with the tango tempo as parallel comparison.

With music rhythm in mind, space as drawing canvas, stacked oval shape with black silhouette and painted with blue and yellow color interpret the image of the embryo split. This is followed by the black frame mirror extending from the ceiling plane to the floor, creating a field of virtual reality. In addition, the interior elevations are plain simple white walls with continuous black baseboard the link all the spaces together. The non-color tone finishes underline the medical space of the intellectual, scientific quality. Chen also explained the symbolic meaning of the color, Blue highlights medical rationality, Yellow fills one with vitality, cool blue and warm yellow are also a symbol of both genders. Cleverly placed mirrors create level changes that enrich the whole space.

The existing structural columns were transformed into cylindrical elements in space, and the dot-like glossy look side tables scatter throughout the space various rounded elements that compose a visually harmonious balance. A lively steam of glow comes from the reception counter, and clusters of small dots printed on the counter surface seem to floating in a bed of liquid. The meandering organic luminous body is a relatively subtle gesture but certainly has a resolute presence.



9



10

9. 天花以黃色和鏡體反射效果來豐富整體感。10. 錯疊的圓象徵細胞分裂，也彷彿探戈男女雙舞時的曼妙步伐。11. 鏡子的運用讓空間色彩即便只有藍與黃，卻能瞬間豐富起來。12. 黑色線條從踢腳板延續至天花圓型鏡體的外框。
9. Small box with yellow ceiling with mirror reflection effect to enrich the space. 10. Overlapping circle of symbolic cell division like a tango's graceful dance pattern. 11. Cleverly utilized mirror in space, instantly enriches the visual experience. 12. Black lines extend from the wall base to the the ceiling plane.



11





13



14



13. 前往手術室和實驗室的內部廊道。14. 廊道另一端的會議室，將卵形語彙作收斂詮釋。15. 會議室空間氛圍理性，顏色僅取用藍與白。16. 平面效果圖。17. 平面圖。
 13. Internal circulation corridor leads to the operating room and laboratory 14. Conference room on the other side of the corridor, the oval language of convergence. 15. Conference room with rational atmosphere. 16. Plan presentation. 17. Plan.

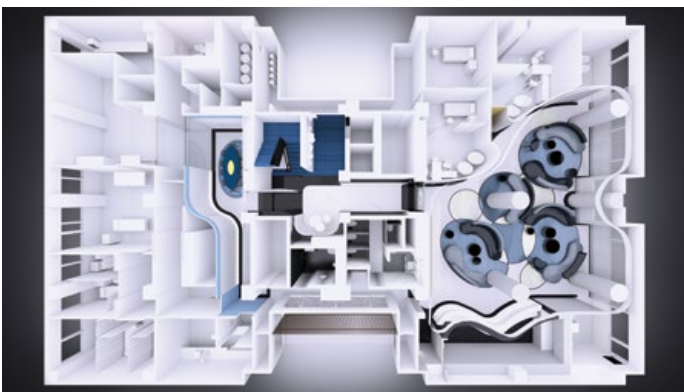

16



17



15

建材分析 Material Analysis

1. 所有立面、地毯等材料都符合醫療的防塵抗菌。2. 梯廳立面如卵子般的裝置，材料為壓克力球。3. 為求空間清潔方便與加強線條，室內用黑色踢腳板做整個收邊。

1. All interior finishes are medical grade antibacterial materials. 2. Staircase elevations with egg shape artwork made of an acrylic ball. 3. In order to facilitate the convenience of cleaning and strengthen the linear design language, all spaces consistently use a black baseboard.

溝通重點 Communication Note

1. 為平衡醫療空間與美學設計上的不同需求，傳統的輕鋼架天花也改成包覆式天花，將空調與光線設計做出簡約而理性的視覺表現。2. 呈現醫療空間美學時，風格也必須掌握醫療院所的專業理性特質，因此色彩應用必須適度拿捏。3. 設計關照醫病雙方感受，創造理性但不失溫度的環境印象。

1. To balance the different needs of the medical space and aesthetic design, Chen replaced the traditional ACT ceiling with an enclosed soffit ceiling integrated with diffusers and lighting. 2. Appropriate color application in the professional medical space. 3. Design with caring in mind for both patient and health care provider, creating a rational and compassionate environment.