

MeeHotel

覓居酒店

設計者」 PANORAMA 泛納設計集團 / 潘鴻彬
參與者」 林穎妍 容忠嘉 潘敏霞 蔡明
攝影者」 深圳市廣大傳媒有限公司
空間性質」 酒店
坐落位置」 中國
主要材料」 竹
面積」 1,876 坪
項目年份」 2019 年

Designer」 PANORAMA Design Group / Horace Pan
Participants」 Wendy Lam, Szeka Yung, Candace Pun, Ming Cai
Photographer」 GD Media, POPO VISION
Category」 Hotel
Location」 China
Materials」 bamboo
Size」 6,200m²
Project year」 2019

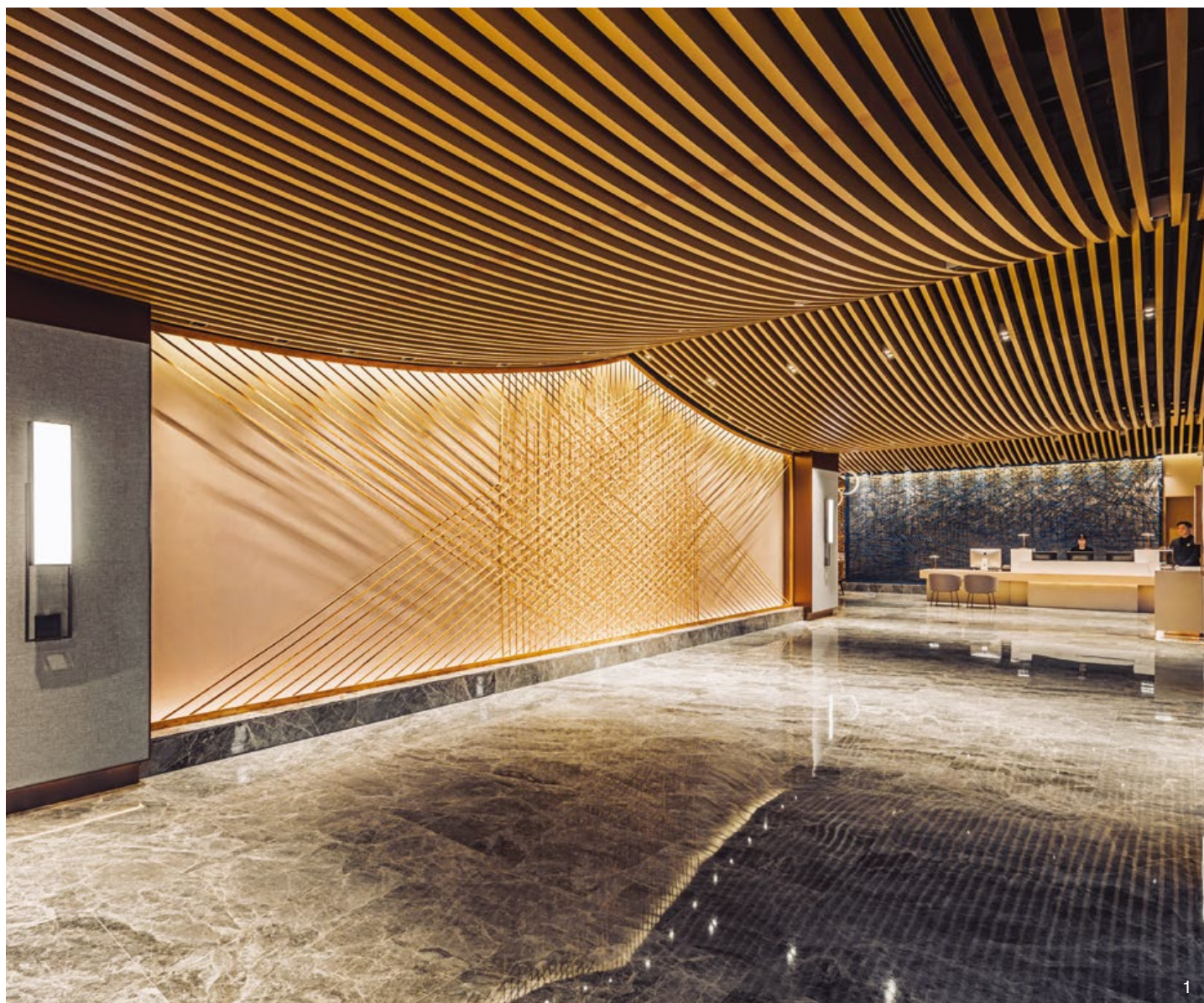

以竹開啟意象，營造真正的竹子林，
為都市增添綠意，並傳承工藝文化。

「竹子林」常被誤認為是一個竹林茂盛的自然地區，但它其實是一個中國鬧區的地名。竹子林位於深圳市中心，面向深圳灣，囊括交通樞紐、高樓大廈，更能遠眺部分山海樹林；而覓居酒店是泛納設計將竹子林在地現有的一棟舊酒店，重新打造的一個新品牌項目。此項目定位為都市休閒酒店，寬闊的高挑感，是業主希望注入的新意象，為此泛納設計透過接待大堂、Sky Café 以及客房三個部分，分別規劃改造。

居於竹林中

覓居酒店以「竹子林」的名字作為概念開啟故事，希望客人從酒店大廳進入時，有種脫離繁忙都市，轉化進入一個沈澱、清淨且優雅的時空。進入空間的第一眼，由竹子串連而成的山形天花，將天花板的最高點與最低點相接形成弧度，透過自然的起伏引導客人前往大廳櫃檯的動線；全高屏風錯落在接待區，編織手法透過計算竹子的厚薄、長短、彈性和能夠穩固豎立的間距，逐一與竹編師傅推敲而出；最後地板、牆面選用暖灰色系作為主建材竹編的基底，燈光的配置含蓄的把光與影從竹編暗藏的光槽裡透出來，讓浮出的竹編構圖藉由燈光形成的影子，打映在硅藻泥牆體上。迎賓大廳透過全高屏風、山形天花板以及硅藻泥飾面牆體，引進的自然風景，讓室內空間室外化，與冷漠的城市景觀形成高度反差。

竹子的結構向上延伸至客房樓層的中庭，每兩層樓面都有一個打通的中庭空間，設計團隊創造了一個湖面倒影飛舞的竹子裝置，雕塑品運用竹子先天的彈性，彎曲成自然落體的曲線，並透過自然焊接法懸掛於頂部、浮於空中，營造竹林氛圍，讓人們環繞、穿越竹林後再進入客房。客房的規劃有兩種，一種是標準房，另一種則是套房，同樣選用暖灰色調襯托，床頭的竹藤造型是客房的主題牆，透過不同的厚度、寬度與大堂形成呼應，床頭背板漂浮在隱蔽的燈光下，為客人提供一個寧靜的環境和優雅的氛圍；衛浴則選用簡約的白色，搭配銀色和古銅色點綴。位於頂樓的 Sky Café 提供客人另一休憩空間，拆除舊有的設計並保留原始建築建構，設計團隊重新以竹子打造出富有禪意的教堂空間；白天，日光會從天窗自然灑落在座位區的中間；到了夜晚，吊頂懸掛的 LED 燈形成一座發光的月亮，為客人提供詩意的體驗。

Horace Pan



PANORAMA 泛納設計集團 / 潘鴻彬
香港 PANORAMA 泛納設計集團創始人
香港理工大學設計學院助理教授
香港室內設計協會副會長

著名為不同商業空間種類創造獨特和敘事性體驗的香港設計師，一直專注於大型的酒店、餐飲、娛樂、零售、別墅及樣板房等複合空間設計。獎項：包括德國 iF 設計獎和紅點設計獎，美國 IIDA 全球卓越設計獎以及 IDA 設計獎，日本 JCD 設計大賞 100 強，APIDA 亞太室內設計獎等。多次被邀請為國際論壇及研討會作主講嘉賓，現更將其設計專業發展到設計教育範例，2016 年和 2017 年分別為香港 APIDAAP 室內設計獎和日本 JCD 設計獎持有國際評委。

PANORAMA Design Group / Horace Pan
Director and founder, PANORAMA
Assistant professor, Hong Kong
Polytechnic University
Deputy director, Hong Kong Interior
Design Association

PANORAMA Design Group has been devoted to multiple commercial space designs such as hotels, restaurants entertainment venues, retail outlets, sample houses and villas. It has won many design awards: IF Design Award, RedDot Award, IIDA Excellent Design Award, IDA Award, JCD Design Award, and APIDA Award, to name but a few. Horace Pan was constantly invited as keynote speakers for International Events and Symposiums. In 2016 he was invited as a juror for the APIDAAP Award 2016 and for JCD Award in 2017.

1. 覓居酒店以「竹子林」的名字作為概念開啟故事，希望客人從酒店大廳進入時，有種脫離繁忙都市，轉化進入一個沈澱、清淨且優雅的時空。

1. Bamboo forest was the main design idea for MeeHotel.



5



6



7



「高度」是設計團隊在執行時遇到的困難，客房中庭以及頂樓 Sky Café 的挑高結構要如何與竹子做結合，必須透過清楚的計算、思考竹子的特性以及裝置的造型，在與竹編師傅討論之下，從圖紙上面逐一推敲，到製成 1:1 的模型確認曲線、長度、比例等，才完成最後的成果。對於泛納設計集團來說，覓居酒店不僅是一個精品酒店項目，更是一個宣揚文化的媒介，除了為繁忙都市提供嶄新的休閒空間，更透過建築、室內設計與傳統工藝的結合展現竹材之美。採訪 歐陽青昀

2. 由竹子串連而成的山形天花。3. 竹子編織的全高屏風錯落在接待區。4. 電梯大廳，地板、牆面皆選用暖灰色系作為主建材竹編的基底。5. 大廳平面圖。6. 客房樓層平面圖。7. Sky Café 頂樓平面圖。8. 透過天花板自然的起伏引導客人前往大廳櫃檯的動線。
2. Bamboo woven ceiling formation in an undulating curve. 3. A grand scale bamboo woven screen right behind the reception area. 4. All surrounding ambience in the reception hall appears in a warm comfort. 5. Reception hall plan. 6. Guest room level plan. 7. Sky Café plan. 8. Bamboo ceiling leads the visual focus towards the reception table.





9. 中庭空間以湖面倒影飛舞的竹子裝置透過自然焊接法懸掛於頂部、浮於空中，營造竹林氛圍。10.11. 設計草圖。12. 重新以竹子打造出富有禪意的教堂空間。

9. Bamboo artwork hangs in the central court in a tranquil impression. 10.11. Design drawing. 12. Sky Café can be used as a ceremonial hall for weddings.

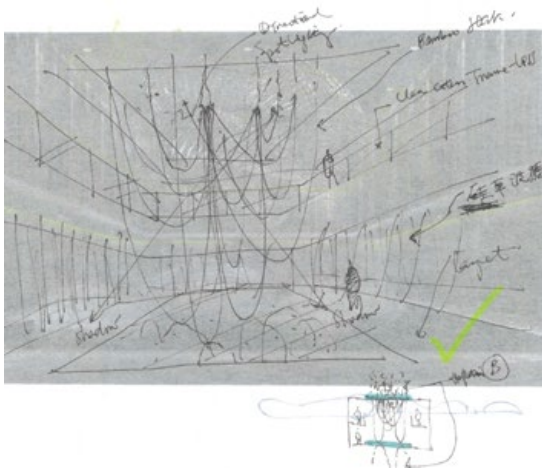

10

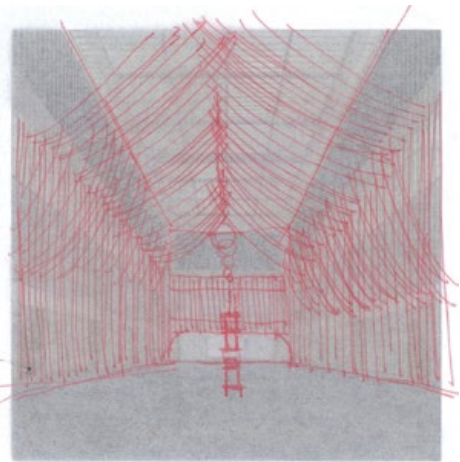

11

建材分析 Material Analysis

1. 覓居酒店以「竹」貫穿整體設計，從接待大廳、客房樓層至 Sky Café，將竹作為主要建材，透過各式編織手法，呈現竹藝之美。2. 接待大廳透過全高屏風、山形天花板以及硅藻泥飾面牆體，引進自然風景，讓室內空間室外化，與冷漠的城市景觀形成高度反差。

1. MeeHotel uses bamboo extensively; bamboo appears in the reception hall, Sky Café and all level guest rooms. 2. A grand bamboo screen in a highly sophisticated craft manner embellishes the reception hall in an exceptional way. Other material uses such as Diatomaceous earth wall further augments the sense of natural comfort.

溝通重點 Communication Note

1. 覓居酒店是泛納設計將竹子林在地現有的一棟舊酒店，重新打造的一個新品牌項目，項目定位為都市休閒酒店，寬闊的高挑感，是業主希望注入的新意象。2. 客房中庭以及頂樓 Sky Café 的挑高結構要如何與竹子做結合，必須透過清楚的計算、思考竹子的特性以及裝置的造型，在與竹編師傅討論之下，從圖紙上面逐一推敲，到製成 1:1 的模型確認曲線、長度、比例等，才完成最後的成果。

1. MeeHotel is a renovation project. PANORAMA Design Group transformed it into a relaxing hotel with a brand-new impression. 2. Bamboo craftwork is highly sophisticated work, integrated to the calculations of the weaving pattern. A 1:1 full scale Mok up was built before the actual grand screen was manufactured.





13



14



15



13. 客房的規劃有兩種，一種是標準房，另一種則是套房。14. 客房衛浴。15. 洗手間。16. 床頭背板漂浮在隱蔽的燈光下，為客人提供一個寧靜的環境和優雅的氛圍。17.18. 以竹開啓意象，編織手法透過計算竹子的厚薄、長短、彈性和能夠穩固豎立的間距，逐一與竹編師傅推敲而出。

13. Two types of guest room: standard and suite style. 14. Bathroom. 15. Restroom. 16. Back lit lighting inside the guest room. 17.18. Bamboo woven technique is a highly sophisticated craftwork relying on tedious calculation and manual work.

Bamboo forest is the name of the region, but the district is right in the hustle and bustle of Shenzhen. Facing Shenzhen Bay, MeeHotel enjoys the regional convenience of traffic and has views to the hillside and ocean. The hotel is a recently renovated aging hotel, and the total transformation will carry a brand-name management team. Three major renewal efforts were the reception space, Sky Café space, and all the guests rooms.

Dwelled in bamboo forest

MeeHotel invites its guests to enjoy its amity by natural submersion. Entering this hotel one is immediately attracted to the scenic surroundings like a bamboo forest. A curving bamboo ceiling invites a gentle approach to the reception table, enclosed by a craftwork bamboo screen. Other materials and supporting lighting fixtures all feature intimate color and textures that match the bamboo. Artificial lighting is cleverly hidden to illuminate right inside the hollow part of bamboo; Diatomaceous earth used on the main walls and its rustic surface provides a sensible reaction to the surrounding light.

The hotel layout has several central courtyards on every two floors in the guestroom quarter. Within every courtyard hangs a bamboo artwork like a flying bird. The bamboo object is gradually transformed and extends its wings to penetrate into the guest rooms. Each standard room or suite room enjoys a similar interior bamboo view and bamboo and rattan materials are woven into the main panels right behind the bed. Lighting features are located in hidden positions. The bathroom is pure white with spots dotted in silver and copper colors.

The Sky Café, located on the top floor offers guests a place for relaxation. The existing old building was partially torn down, and reuses the remaining structural elements to construct a bamboo building. The building invites natural light to enter from a skylight and provides a total wonderment experience to the sky at night. An illuminating object like a moon hangs in a position attracting one's visual focus in this Café.

The design team had to tackle many technical problems for each of the bamboo objects. To hang the object under a high ceiling was not easy particularly those in the central courtyard of the rooms' area and Sky Café. To manufacture and hang the objects in the right position incurred endless discussion and even the use of 1:1 full-scale models to make sure every joint detail and the scale was right. PANORAMA Design Group's effort contributed not just to the rejuvenation of the old facility but also elevated the craft of bamboo art in the very demanding interior furnishings in a hotel project.