

# Afterain

## 花時餐廳

**設計者** 峻佳設計 / 陳峻佳 吳志湖 溫民偉 歐金輝  
**參與者** 舒豔 顏蘭 金芙蓉 楊志平 張力陽 李振堂 許妍欣  
沈琳晨 何思穎 吳綺琪  
**攝影者** 歐金輝 肖恩  
**空間性質** 餐廳暨接待中心  
**坐落位置** 中國  
**主要材料** 木飾面、灰色水磨石、木紋地磚、白麻石、超白玻璃、噴砂不銹鋼、黑鏡  
**面積** 219 坪  
**項目年份** 2020 年

**Designers** Karv One Design / Kyle Chan, Derek Ng, Jacky Wan, King Ou  
**Project Team** Sophie Shu, Larrissa Yan, Florine Jin, YangYang, Leon Zhang, Bruce Li, Nicko Hui, Hannah Shen, Cvin Ho, Katie Ng  
**Photographer** King Ou, Sean  
**Category** Restaurant  
**Location** China  
**Materials** wood veneer, terrazzo, wood grain ceramic floor tile, ultra white glass panel, paint, marble, stainless Steel, coated mirror  
**Size** 725m<sup>2</sup>  
**Project year** 2020



滿目綠意如身處於雨後山林之中，兼營精緻細節與材質比例，巧取質感與放鬆的平衡，使五感皆沉浸於自然體驗，於都會中打造一座森林餐廳。

踏入餐廳的第一眼即受到大片綠意包裹，自窗外景觀至室內豐富的植栽一路延伸至桌上清新的佳肴，令人感覺彷彿誤闖了森林中的饗宴，設計師以「自然主義」為設計主軸，從視覺、聽覺、觸覺與味覺打造一場沉浸式的用餐體驗。本案坐落於杭州

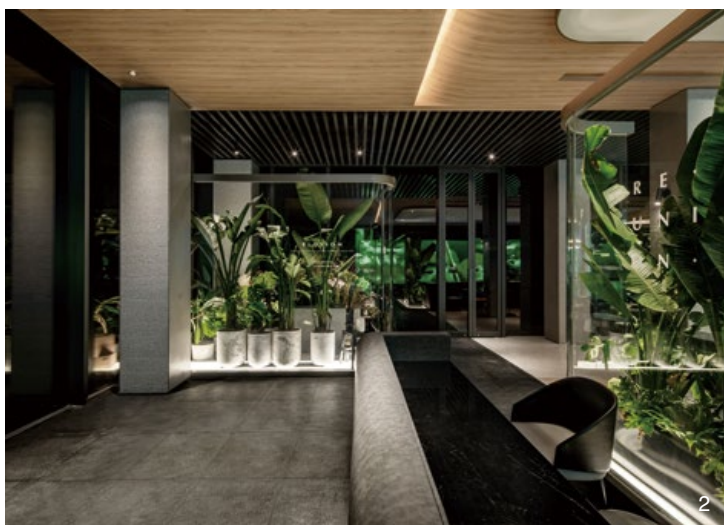

市郊新落成的社區內，除了作為社區內的商業載體交付第三方餐飲集團營運，成為居民交流、聚會場所之一，在銷售期間亦需兼作接待中心，業主期待延續建案對於「美好生活」的願景，而行銷功能穿插於其中又必須不顯突兀。峻佳設計接下了這道困難的挑戰，以人們生活息息相關的「飲食」串聯，透過餐廳空間連結起自然、人、生活三者。

「雨後的山林，萬物煥然一新，此時此景，花一點時間享受美食，大概是最美妙的。」設計師分享道，以此概念出發，餐廳定名為「Afterrain 花時餐廳」，期待客人於此花費時間、徜徉自然。設計運用「四季」元素，將空間區分為四大主題：提供兒童遊玩的「春櫻樂園」、飲品調製吧台「半夏咖啡」、「秋木輕食」為主要用餐座位區、「冬青私宴」則是 VIP 包廂。餐品設計也順應主題，通過順應時節的自然主義簡餐料理，讓人完全沉浸在獨特的餐廳氛圍中。

## Kyle Chan



峻佳設計 / 陳峻佳  
峻佳設計公司創始人，WYDF 世界青年設計師全球總冠軍，光華·龍騰中國裝飾設計業十大傑出青年，香港設計新勢力代表人物，思度建築及室內設計合夥人及亞太區設計總監，曾獲「亞太區年輕設計師大獎」室內設計金獎，美國著名室內設計雜誌《Interior Design》Best of Year Awards 等。峻佳設計 2008 年創立於香港，在廣州、深圳、南京設有分公司，是集商業策劃、空間設計、品牌設計與整合傳播等全流程為一體的跨界創新商業設計公司。曾服務多家大型知名地產商、文化空間運營商、連鎖商業品牌、教育品牌等；在商業地產、零售、文化、教育、辦公、公共服務空間領域皆有代表案例。

Karv One Design / Kyle Chan  
Kyle Chan, the founder of Karv One Design, WYDF World Young Designers Global Champion, Guanghua Longteng China Interior Design Industry Top Ten Outstanding designee, Hong Kong New Design Force representative, Sidu Architecture and Interior Design Partner and Asia Pacific Design Director, has won the "Asia Pacific Young Designer Award" interior design gold medal, US Interior design magazine "Best of The Year Design Awards" and many others. Karv One Design founded in Hong Kong in 2008, with branch offices in Guangzhou, Shenzhen and Nanjing, is an innovative business design company. It provides a full range of services including business planning, space design, branding and integrated communication. It has served a number of large-scale well-known real estate developers as well as clients in the cultural, educational, office, public service space resulting in a wide range of successful projects in numerous fields.

1. 以「自然主義」為概念打造都會中的森林餐廳。
  2. 入口處以花卉植栽作為意象裝置，點明空間主題。
1. A forest restaurant in the city with naturalism as the design concept.  
2. Entry vestibule features a floral installation.



## 森林中的餐廳

全作動線依照機能安排，將主要人群聚集的用餐區、飲品吧台置於前區，後區則為兒童遊樂區、VIP 包廂及辦公間，藉此分流客群，維護隱私。而如何克服 L 字型基地劣勢，打造連貫順暢的主題式體驗，成為設計上的另一難題，設計師於每一個區域設定富有故事的記憶點，以藝術化手法將行銷考量穿插其中，讓空間遊逛成為一場趣味性的探索之旅。全案定調於高級餐廳質感，因此壁面、沙發座椅皆以深色系為主，予人沉穩、寧靜之感，前區以淺色木材天花及地坪相襯綠意，為進入餐廳的客人放鬆、舒緩情緒。設計師提到，植栽作為主要元素，除了部分固定植物外，其餘盆栽造景皆可隨季節、節日更換，讓視覺更親切且具多樣性，並加強「四季遞嬗」的時光流逝感。

飲品吧台位於基地近轉折處，善用建築原有的天井引入自然日光，結合大片落地窗的景觀，塑造開放視覺，並於方形吧台中央植入樹木，成為視覺焦點。設計師將天井劃分格狀，強調白日光影效果，內側選擇白色提高整體亮度；夜間燈光亦沿格狀亮起，呈現更為精緻的氛圍，吧台座位無論日夜都可享受到光線自頂上穿越枝葉形成的樹蔭，使空間更融於自然之中。

後區布局依照隱私需求編排，依序為半高的兒童遊戲區、VIP 包廂，以及以水泥材質封閉的辦公區，大量運用圓弧玻璃隔間劃分區域，保留視覺穿透性。圓弧線條則於高級餐廳的正式、儀式感與自然輕鬆氛圍間取得平衡，並於玻璃內栽植造景，使植物成為如藝術品般的存在。本作透過滿室的綠意遍布，使食客在享受自然主題餐食的同時，飽覽四時風景，如坐森林之中，設計師期待打造一個豐富疊加不同內容與場景的空間，讓人能在短時間內感受到多層次的體驗，從而釋放來訪者對生活的感受力。採訪」林慧慈



3. 飲品吧台區，中央植栽凝聚視覺焦點。4. 入口接待處，引導後續服務動線。5. 輕食用餐區，深色調軟裝點綴雅致氛圍。6. L 型基地為設計時一大挑戰。7. 後區機能劃分三區，以玻璃隔間劃分空間，維護視覺通透。

3. Central planting zone as spatial feature. 4. Entry reception, the origin of the service circulation. 5. The main dining space with dark color scheme finishes. 6. L shaped floor plate posed various design challenges. 7. Glass partition separates different functional spaces but retains the visual connection.





8

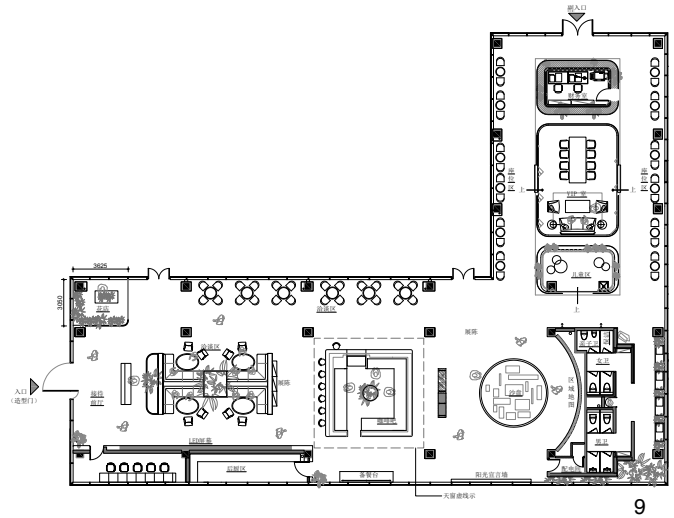

9

8. 圓弧隔間造型提供放鬆與高雅兼具的用餐環境。9. 平面圖。  
8. Curved partition walls gracefully subdivides the space into elegant dining zones. 9. Floor plan.

As soon as one steps into the restaurant, one is immediately greeted with an abundance of green, from the landscape view outside of the window and lavish indoor plantings extending all the way up to the table top with refreshing cuisine like stepping into a forest feast. "Naturalism" is the concept behind the main design scheme, resonating with different sensations from the visual, auditory, tactile, and taste to create an immersive dining experience.

The project is located in a newly completed community on the outskirts of Hangzhou. In addition to serving as a third-party operating restaurant operations, it also serve as a center for community activities. The public gathering space also doubles as the development sales reception center as the owner looks forward to extending the "good life" vision from the overall design concept into the marketing approach. Karve One Design took on this difficult challenge, closely linking food together with nature, people and daily life in the restaurant space. As the designer noted in the forest, everything seems rejuvenated after the rain so that is probably the most delightful sight and place to enjoy cuisine. Starting with this notion, the restaurant is named "Afterrain Floral Theme Restaurant" and guests are expected to spend time leisurely experiencing nature.

The design uses the "Four Seasons" concept to divide the space into four main themes: "Spring Sakura Park" for children to play, "mid-Summer Cafe" at the beverage bar, "Autumn delight" as the main dining seating area, and "Holly Private Banquet" are the VIP rooms. The menu design also conforms to these theme, through the naturalistic minimalist cuisine, allowing patrons to completely immerse themselves in the unique restaurant atmosphere.



10. VIP 包廂，提供多人聚會使用。11. 兒童遊樂區，兼顧家庭用餐需求。12. 洗手間內部，淺色木材跳脫用餐區視覺。13. 洗手台設計結合玻璃盒及植栽，創造生活與自然相融之感。14. 盥洗區以拱門造型延續圓弧語彙。

### The restaurant in the forest

The overall circulation is organized in accordance with the spatial functions. It accommodates large crowds in the main dining area and a beverage bar is located in the front area. The children's play zone, VIP rooms and offices are in the rear portion of space to maintain privacy and avoid crowds.

The main design challenge was to overcome the disadvantage of the L-shape floor plan and create a comprehensible thematic experience. The designers customized a memorable story at each designated area and artistically intersperse marketing material thereby making travel through the spaces a fun exploratory trip.

The project is defined as a fine dining restaurant and mainly uses darker color textile finishes that render a more calming sense. Whereas the front area's light wood ceiling and floor finishes serve as a backdrop for the greenery to offer a tranquil atmosphere for guests to relax and soothe their mood. Designers mentioned that, as the main design element, other than some fixed plants the majority of the landscape potted plants can be changed out based on the seasons and holiday festivals needs to provide diverse visual interests and enhance the sense of the four seasons and the passing of time.

The beverage bar is located at the pivotal point of the floor plan taking advantage of the existing atrium to introduce natural daylight into the core of the space. Large floor-to-ceiling full height windows open up the space. Carefully selected feature trees planted at the center of the square shape of the bar are the visual focus. The designers subdivided the atrium into gridded shapes giving emphasis to the daylight and shadow effect, while also using white to finish the interior side of atrium to enhance the overall brightness. Lighting illuminates the grid at night defining a more refined atmosphere. Seated along the bar counter one can experience the light changes sifting down from above mimicking the sunlight filtering through the shade of the leaves.



10



11



12



13



14

10. VIP private room for group gatherings. 11. Children play zone. 12. Restroom interior details. 13. Hand wash sink counter with integrated planter; nature takes part in daily life. 14. Arch framed opening extends the curved design language.

The rear portion of the plan layout in accordance with privacy needs. Low height partitions define the children's play area, VIP private rooms and concrete wall finished office space. Large amount of curved glass partitions were inserted to subdivide space but maintain visual penetration. Curved glass wall with plants forming a green landscape artfully position the high-end restaurant somewhere between a ceremonial formality and a sense of relaxed nature achieving a balanced atmosphere. Karv One Design created a very rich overlay of different content and scenes of space. This green project allowing diners to enjoy the natural theme of cuisines and at the same time enjoy the seasonal scenery, almost like sitting in the middle of forest where a visitor can enjoy a multi-level experience in a short period of time.

### 建材分析 Material Analysis

1. 前區天花板運用淺色木皮與深色格柵，木材質營造輕鬆自然氛圍，格柵創造層次。2. 善用基地原有天井，下方安排吧台及中央植栽，成為空間視覺焦點。3. 後區使用圓弧玻璃作為隔間劃分區域，保持視覺通透性，並藉由材質提升空間質感。  
1. The front area ceiling has a light color wood veneer paired with dark grilles. Wood texture sets up a relaxing natural atmosphere. 2. Beverage bar and central planting zone is directly below the existing atrium and is the focal point of the space. 3. The rear area uses curved glass partitions to subdivide space based on functional needs, but maintains visual permeability and enhance the texture of space by material.

### 溝通重點 Communication Note

1. 以「自然」為設計主軸，於都會中創造彷彿於森林中用餐的環境。2. 本案兼具餐廳及接待中心機能，必須在不對餐飲空間造成影響下滿足行銷需求。3. 需克服 L 型基地劣勢，打造沉浸式體驗主題空間。  
1. "Nature" is the main design concept to create a dining in the forest environment in the middle of the city. 2. This project combines the functions of a restaurant and a sales reception center and must meet marketing needs without affecting the dining space. 3. The main design challenge was to overcome the disadvantages of the L-shaped floor plan and create an immersive experience.